

THE **QUINCIE** GREASE GUN
MODELS 10600 & 10680
INSTRUCTIONS

(Be sure to read complete instructions before using these Guns)

I. OPERATION & DESCRIPTION

All models of the **QUINCIE** Grease Gun are high-pressure tools that should be used with caution and according to these instructions. **IMPORTANT - Do not exceed 10,000 psi for model 10600. Do not exceed 15,000 psi for model 10680.** These guns are screw prime, lever operated. After loading the Gun (see II. LOADING) prime the Gun (see II. F). The Gun is now ready for operation.

During operation, lever action of the Plunger Handle (16) causes the Plunger (17) to move in and out of the Head (1). As the plunger (17) goes into the Head (1), it forces the material (lubricant, packing, sealant, or cleaner) from the Barrel (9) out through the Head (1) discharge port. Numerous options are available for Head (1) attachments to transmit material to the desired pump, valve, or other equipment. Be sure to have the appropriate material transmission apparatus or hose assembly firmly attached to Head (1) before Gun operation.

The (numbers) shown herein refer to Parts List 371-1098 and 372-1098.

To ensure the **QUINCIE** Grease Gun will perform and operate properly, use after use, keep the gun out of the weather, clean, and maintained.

II. LOADING

Each new **QUINCIE** Grease Gun is ready to use, following this procedure:

- A. To load the **QUINCIE** screw prime, lever operated Grease Gun(s) with material (lubricant, packing, sealant, or cleaner) remove the Primer Assembly* from the Barrel (9) by unscrewing the Collar (10) from the Barrel (9).

*Primer Assembly 10668 includes:

Screw Handle (11)	Part No. 10612
Collar (10)	Part No. 10611
Primer Spring Assembly	Part No. 10673

- B. Pull the Primer Assembly (10688) out of the Barrel (9).
- C. Screw the Collar (10) towards the Primer Spring Assembly (6) to the end of thread engagement. Make sure Collar (10) does not jam against Primer Spring Assembly (6).
- D. Load the Barrel (9) with material in either "J" or "K" size sticks, bulk. If loading with bulk, leave room in the Barrel (9) for the Primer Spring Assembly (6).
- E. Push the Primer Assembly (10688) into the Barrel (9) and screw the Collar (10) on the Barrel (9), by hand, until full thread engagement.
- F. To prime the gun, turn the Screw Handle (11) clockwise so that the Primer Spring Assembly (6) collapses and reaches complete compression.
- G. Always make sure the Head (1) and Collar (10) are firmly attached to the Barrel (9) and be sure there is full thread engagement between these parts before Gun operation.
- H. Engage Gun Head (1) discharge port, hose, coupler or other material transmission apparatus with fitting or other receptive device. Make sure connection is secure.
- I. The Gun is now ready for use.
- J. As the Gun loses its prime, repeat procedure F until material is completely discharged.
- K. Repeat procedures A through J as necessary. Before Procedure A is completed, be sure Primer Spring Assembly (6) is not compressed and Screw Handle (11) is turned counter-clockwise before removing Primer Assembly (10688) from Barrel (9). There must be no tension on the Primer Spring Assembly (6).

To remove the Gun from operation, make sure there is no backpressure. Back-off (turn counter-clockwise) the Screw Handle (11).

IMPORTANT --- Warranty will be void if Gun is altered.

NOTE --- Contact **Quincie Oilfield Products** for other operation, repair, or rebuilding procedures.

GREASE GUNS, 10,000 PSI
MODELS 10600 AND 10610 - PARTS LIST
 Hand Lever, Screw Prime

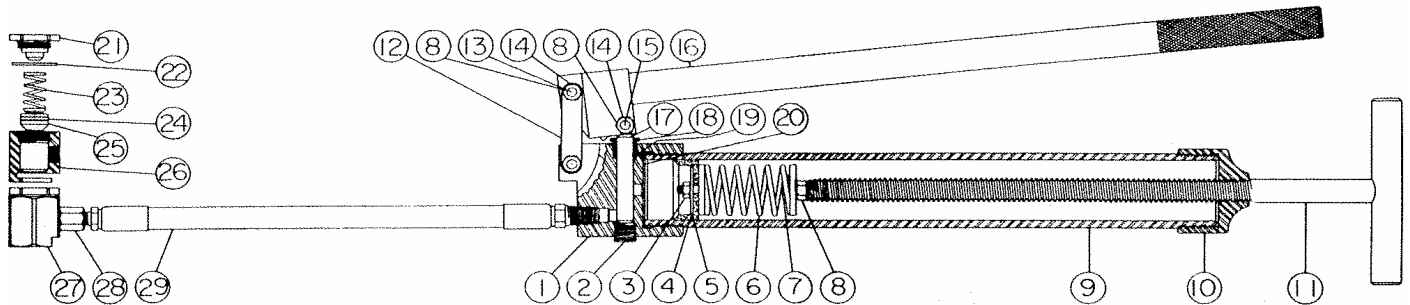

Ref. No.	Part No.	Description	Ref. No.	Part No.	Description
1	10601	Head	16	10617	Plunger Handle
2	10602	Plug	17	10618	Plunger
3	10603	Nut, 1/4" - 28 NF	18	10619	Packing Nut
4	10894	Primer Cup	19	10621	Packing
5	10605	Washer	20	10622	Head Gasket (optional)
6	10606	Primer Spring Assembly	21	10623	Coupler Cap
7	10607	Screw, 1/4" - 20 NC x 1"	22	10624	Gasket
8	10608	Nut, 1/4" - 20 NC	23	10625	Coupler Spring
9	10609	Barrel	24	10626	"O" Ring
10	10611	Collar	25	10627	Coupler Piston (Nylon)
11	10612	Screw Handle	26	10628	Coupler Body
12	10613	Link (2 required)	27	10630	Grease Button Head Coupler
13	10614	Stripper Bolt (2 required)	28	10629	Coupler Adapter
14	10778	Lock Nut (3 required)	29	10631	Hose, 12"
15	10779	Stripper Bolt			